

MICHAELANASTASSIADES

INSTALLATION INSTRUCTIONS

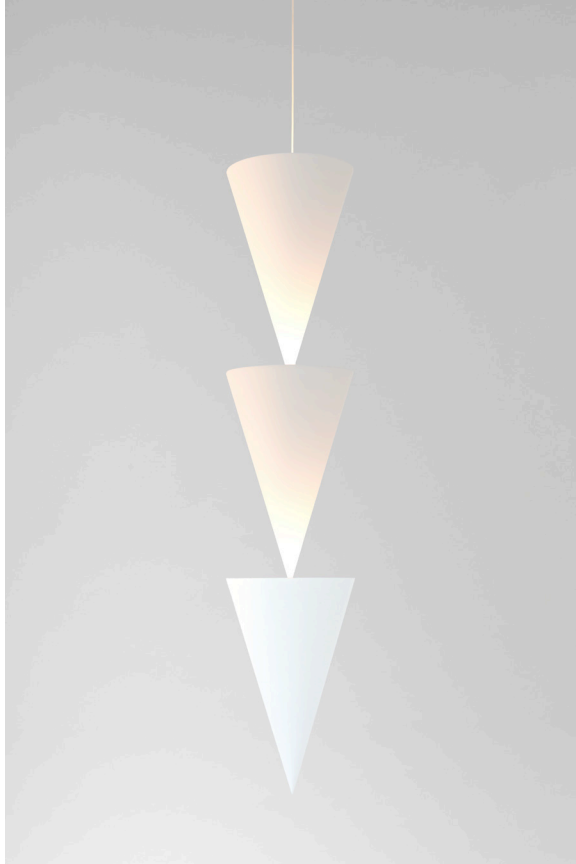

PEAKS
PEAK, TWIN PEAK, TRIPLE PEAK, UP & DOWN, 2023

PRODUCT SPECIFICATIONS

PEAK

Bulb specifications: 120V / 240V

Integrated LED 20W
dimmable triac or dali

Product weight: ~2kg

TWIN PEAK

Bulb specifications: 120V / 240V

Integrated LED 40W
dimmable triac or dali

Product weight: ~4kg

TRIPLE PEAK

Bulb specifications: 120V / 240V

Integrated LED 60W
dimmable triac or dali

Product weight: ~6kg

BEFORE INSTALLING

Please keep these instructions for future reference.

Please read instructions in full prior to installation noting all illustrations. Instructions should be followed precisely.

If you are in any doubt, consult a qualified electrician to install the fitting.

Install in accordance with current national or local wiring regulations.

Ensure the circuit, to which the fitting is to be connected, has been installed and fused in accordance with local electrical standards.

Disconnect the electrical supply at the fuse box. Switching off via a wall switch is not adequate.

The fitting is for use in a normal dry domestic indoor environment. Suitable for mounting on non-combustible surfaces only.

If removing an existing fitting, carefully note all wiring connections and record which of the wires is connected to which terminal.

Carefully identify the supply cable. Check there are no other cables in the area to avoid damage to concealed wiring during installation.

Please make sure the wires are matching to the correct connectors according to live, neutral or earth (ground).

Position the light where desired, ensuring that the area is suitable to support the weight of the light.

Determine the fixing method appropriate to the surface material.

Modifying any part of the light will void the products warranty.

Michael Anastassiades accepts no liability for incorrect use of the mentioned object.

CLEANING INSTRUCTIONS

Before cleaning, lighting fixtures must be turned off and unplugged from mains electricity. Whilst cleaning please take care and use the gloves provided.

Powder coated finish: Use a lightly damp soft dust cloth and gently go over marks until clean. Dry it afterwards with a soft dust cloth. Make sure the product is completely dry before switching the electricity on.

Parts Supplied: Lamp Body

PEAK UP



PEAK DOWN

TWIN PEAK UP

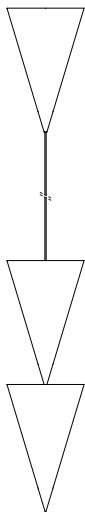

TWIN PEAK DOWN

TRIPLE PEAK UP

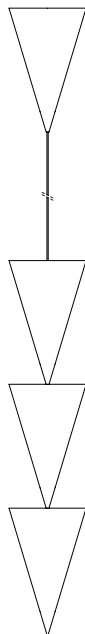

TRIPLE PEAK DOWN

Additional Items Provided

Spare Kit Bag

Additional Requirements

Power Drill and Bits

Mounting Screws and Wall Anchors

Fig. 1

Rotate the ceiling rose cover (A) anti-clockwise to unscrew and release from the back plate (B).

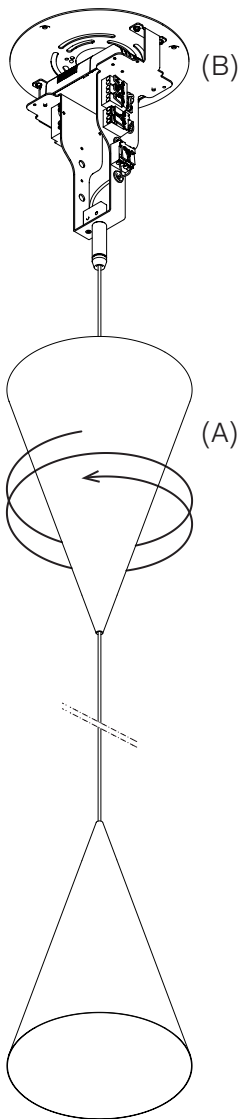

Fig. 2 For 240V Fittings

Place the back plate (B) onto the wall, centre it to the mains electrical supply cables and mark the holes to be drilled. Once drilled, insert wall anchors into the holes, ensuring that the area is able to support the entire weight of the fixture (noted on product specification). Screw the back plate onto the wall, making sure it is levelled. Pull live, neutral and ground cables (and low voltage dimming cables for dali option) out through the central hole.

Determine the fixing method appropriate to the surface material before starting the project. Use fixings that are suited to the surface material and are sufficient to bear the weight of the light.

Go to Fig.4 for next step.

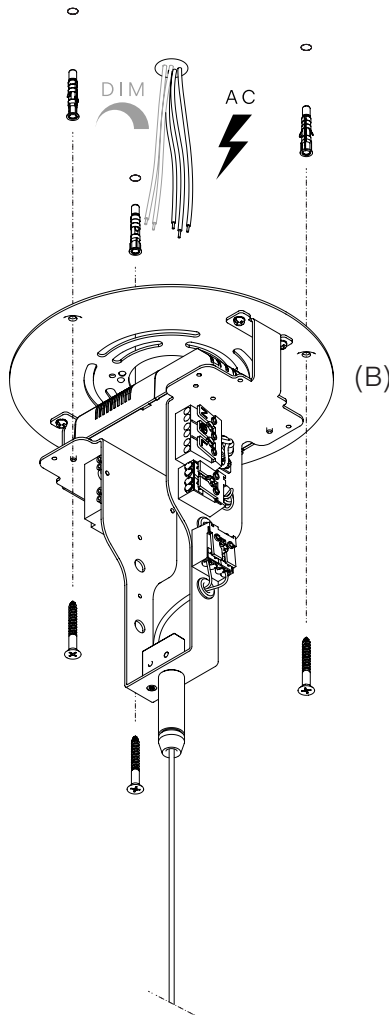

Fig. 3 For 120V Fittings

Screw the back plate (B) onto the junction box, making sure it is levelled. Pull live, neutral and ground cables (and low voltage dimming cables for dali option) out through the central hole.

Mounting screws are not supplied with this fixture as J-boxes can vary.

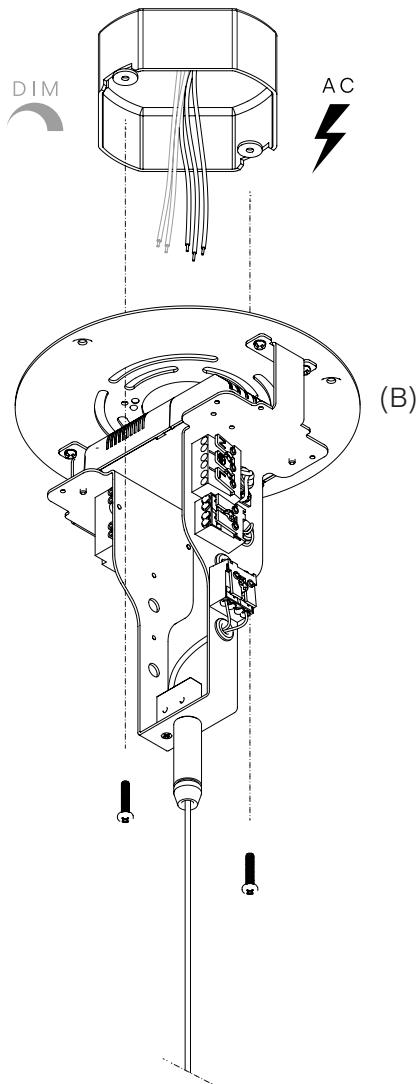

Fig. 4

Triac dimming option:

Connect the live, neutral and earth of the mains electrical cable to the terminal block of the fixture. Make sure all electrical cables match correctly.

Dali dimming option:

Connect the live, neutral and earth of the mains electrical cable to the terminal block of the fixture. Connect the dimming cables to the dimmer terminal block, respecting the polarity. Make sure all electrical cables match correctly.

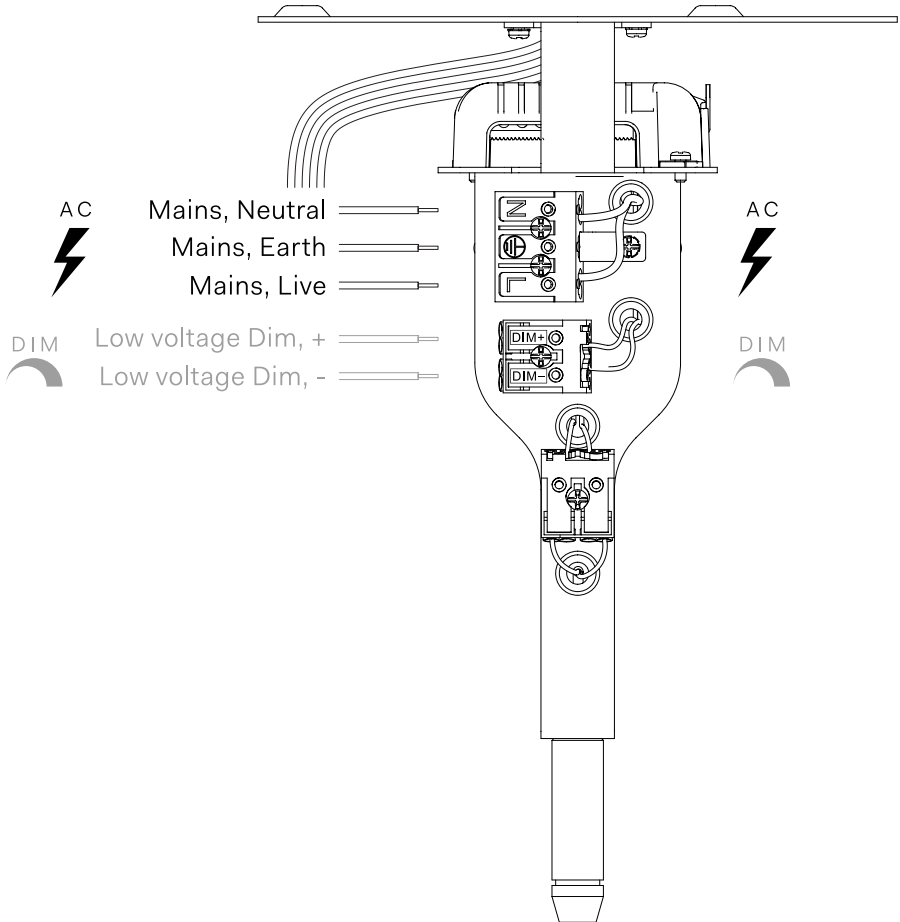

Fig. 5

Adjust the cable length to obtain the desired lamp drop.

See Cable Connection Guide for further reference.

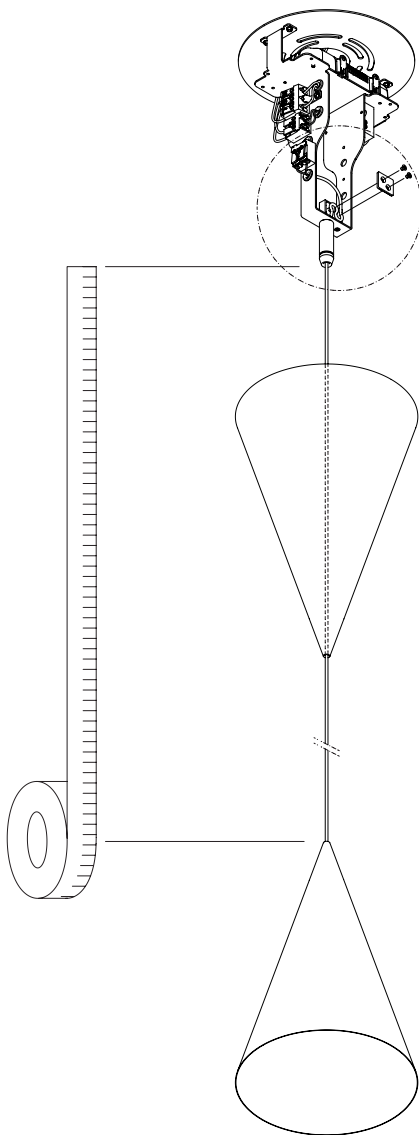

Fig. 6

Place the cable in the cord restraint (C) to secure the lamp at the desired length. If the remaining cable is too long to fit in the ceiling rose, follow the next steps.

1. Cut the cable. 2. Strip the coaxial cable. Twist the external negative cable. 3. Apply the provided sleeve from the spare kit to electrically isolate the exposed negative cable. 4. Place the cable in the cord restraint (C), checking the desired lamp drop. Close the cord restraint (C) with the provided screws. 5. Insert the cables into the lamp's terminal block, respecting the polarity.

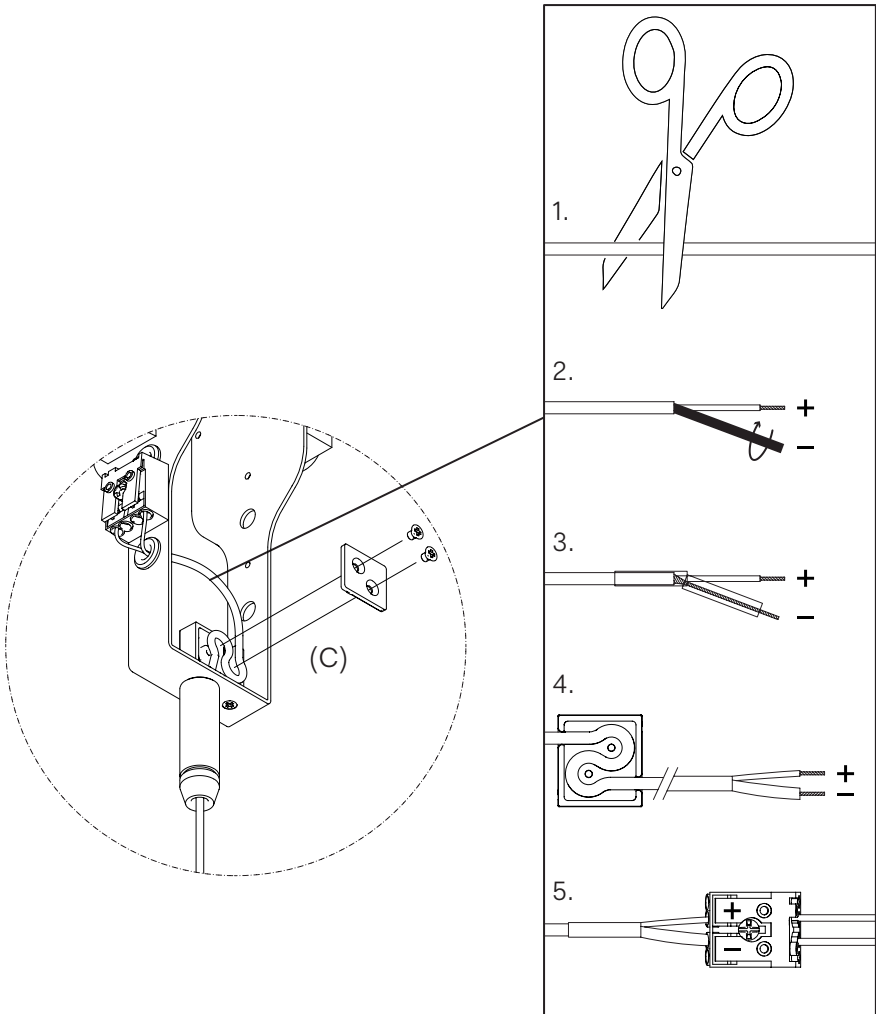
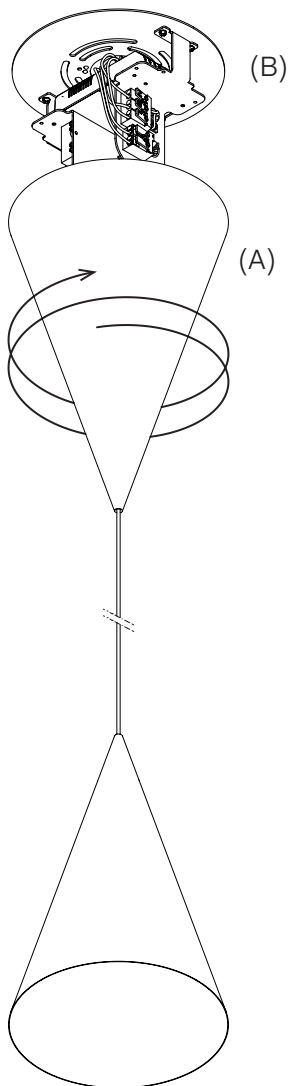

Fig. 7

Screw the ceiling rose (A) onto the backplate (B).



Michael Anastassiades' design philosophy is to preserve the inherent qualities of given materials. All of our products are handmade and come in natural finishes, exposed to the elements without any protective lacquers. We look at oxidisation as part of a process that adds to the patina of an object, increasing beauty with time. We try our best for all goods to leave our premises in pristine condition, but sometimes products may arrive with minor oxidisation marks.

Whilst every effort is made to ensure an accurate representation of product colours, finishes and dimensions, Michael Anastassiades Ltd reserves the right to alter these details without notice, in compliance with its own production needs, technological changes or in response to the current market needs. Colour swatches are for reference only; Michael Anastassiades Ltd cannot guarantee exact colour match for any product finishes.

All designs are protected under copyright law. Michael Anastassiades holds the exclusive manufacturing and distribution rights worldwide. Copying will be prosecuted.

All light fixtures in this catalogue have UKCA/CE marking compliance.

Michael Anastassiades Ltd.
50 Rochester Place, London NW1 9JX
T +44 (0)20 7928 7527
sales@michaelanastassiades.com
www.michaelanastassiades.com
© 2023 Michael Anastassiades Ltd. All rights reserved.